

NOTES:

OWNER'S SIGNATURE

*(Signature)*

LIM JING YIH

IC NO. 00-284771(K)  
NO.4, SIMPANG 185, KAMPUNG SUBOK,  
BD 2717, BRUNEI DARUSSALAM

COMPANY NAME



**DESIGN TEAM**

CHARTERED ARCHITECT  
P.O. BOX 96, SERI COMPLEX BA1779  
TEL. NO. 673-2-652564 / 673-2-652565

PROJECT NAME AND LOCATION:

PROPOSED 2-STORY  
SEMI-DETACHED HOUSE ON LOT 58399  
AT KAMPUNG SUBOK, MUKIM KOTA BATU  
NEGARA BRUNEI DARUSSALAM

SHEET CONTENTS:

SITE DEVELOPMENT PLAN

SCALE	DESIGN BY:	
	DRAWN BY:	
	DATE:	
	ARCHITECT	DESIGN TEAM
SHEET NO.		

00

**SITE DEVELOPMENT PLAN**

SCALE 1: 200 MTS.

DESIGN TEAM/DATA

Latest

Garage = 40.1ft

8780

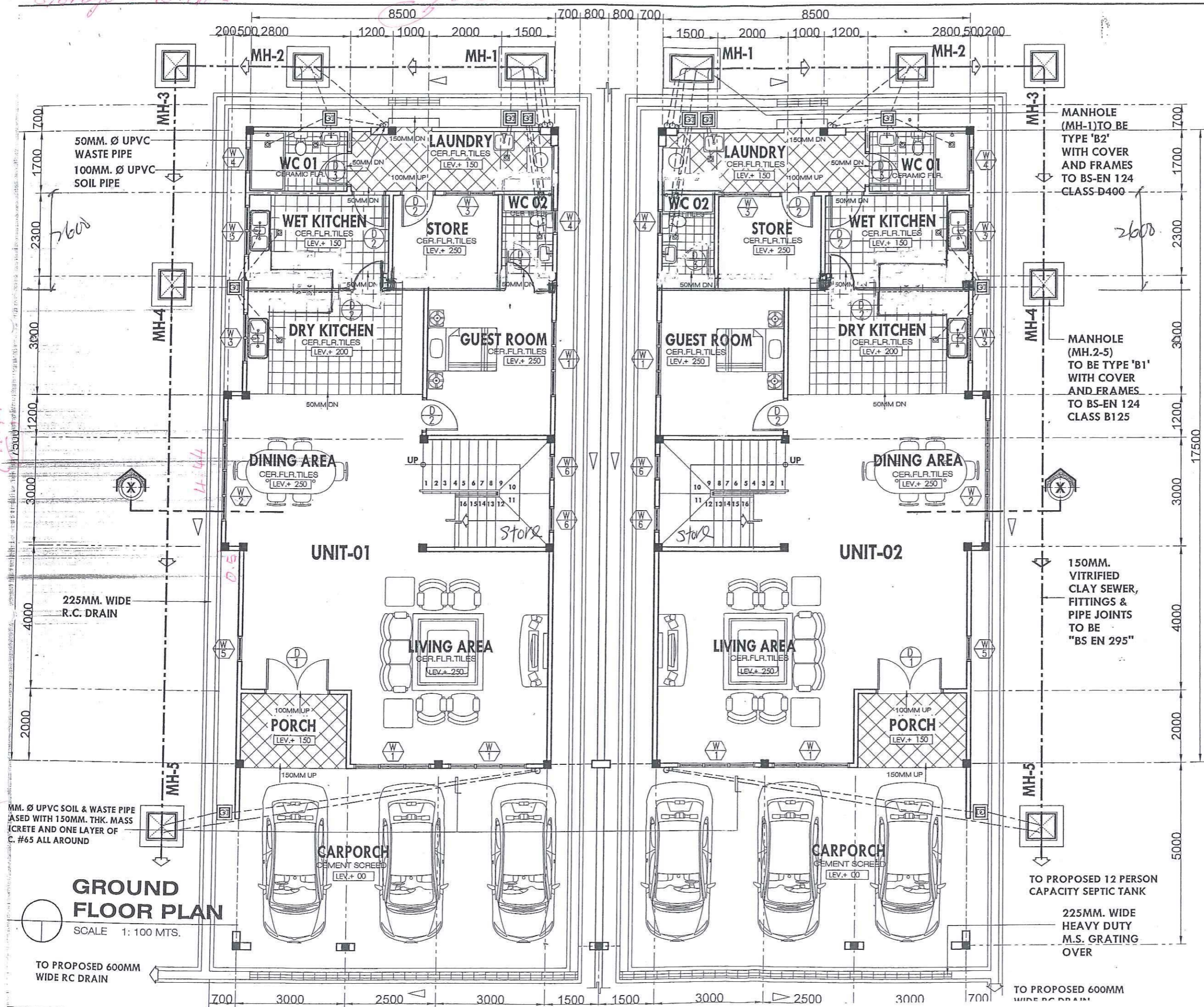

NOTES:

MANHOLE (MH-1) TO BE TYPE 'B2' WITH COVER AND FRAMES TO BS-EN 124 CLASS-D400

MANHOLE (MH-2-5) TO BE TYPE 'B1' WITH COVER AND FRAMES TO BS-EN 124 CLASS B125

150MM. VITRIFIED CLAY SEWER, FITTINGS & PIPE JOINTS TO BE "BS EN 295"

TO PROPOSED 12 PERSON CAPACITY SEPTIC TANK

225MM. WIDE HEAVY DUTY M.S. GRATING OVER

TO PROPOSED 600MM WIDE RC DRAIN

OWNER'S SIGNATURE

**LIM JING YIH**  
IC NO. 00-284771(K)  
NO.4, SIMPANG 185, KAMPUNG SUBOK,  
BD 2717, BRUNEI DARUSSALAM

COMPANY NAME



**DESIGN TEAM**  
CHARTERED ARCHITECT  
P.O. BOX 96, SERI COMPLEX BA1779  
TEL. NO. 673-2-652564 / 673-2-652565

PROJECT NAME AND LOCATION:

PROPOSED 2-STORY  
SEMI-DETACHED HOUSE ON LOT 58399  
AT KAMPUNG SUBOK, MUKIM KOTA BATU  
NEGARA BRUNEI DARUSSALAM

SHEET CONTENTS:

GROUND FLOOR PLAN

SCALE	DESIGN BY:	
	DRAWN BY:	
	DATE:	
	ARCHITECT	DESIGN TEAM
	SHEET NO.	

02

DESIGN TEAM/DATA

# GROUND FLOOR PLAN

SCALE 1: 100 MTS.

TO PROPOSED 600MM WIDE RC DRAIN

MM. Ø UPVC SOIL & WASTE PIPE  
ASED WITH 150MM. THK. MASS  
CRETE AND ONE LAYER OF  
C. #65 ALL AROUND

225MM. WIDE  
R.C. DRAIN

50MM. Ø UPVC  
WASTE PIPE  
100MM. Ø UPVC  
SOIL PIPE

17.74

14.44

0.5

7600

2600

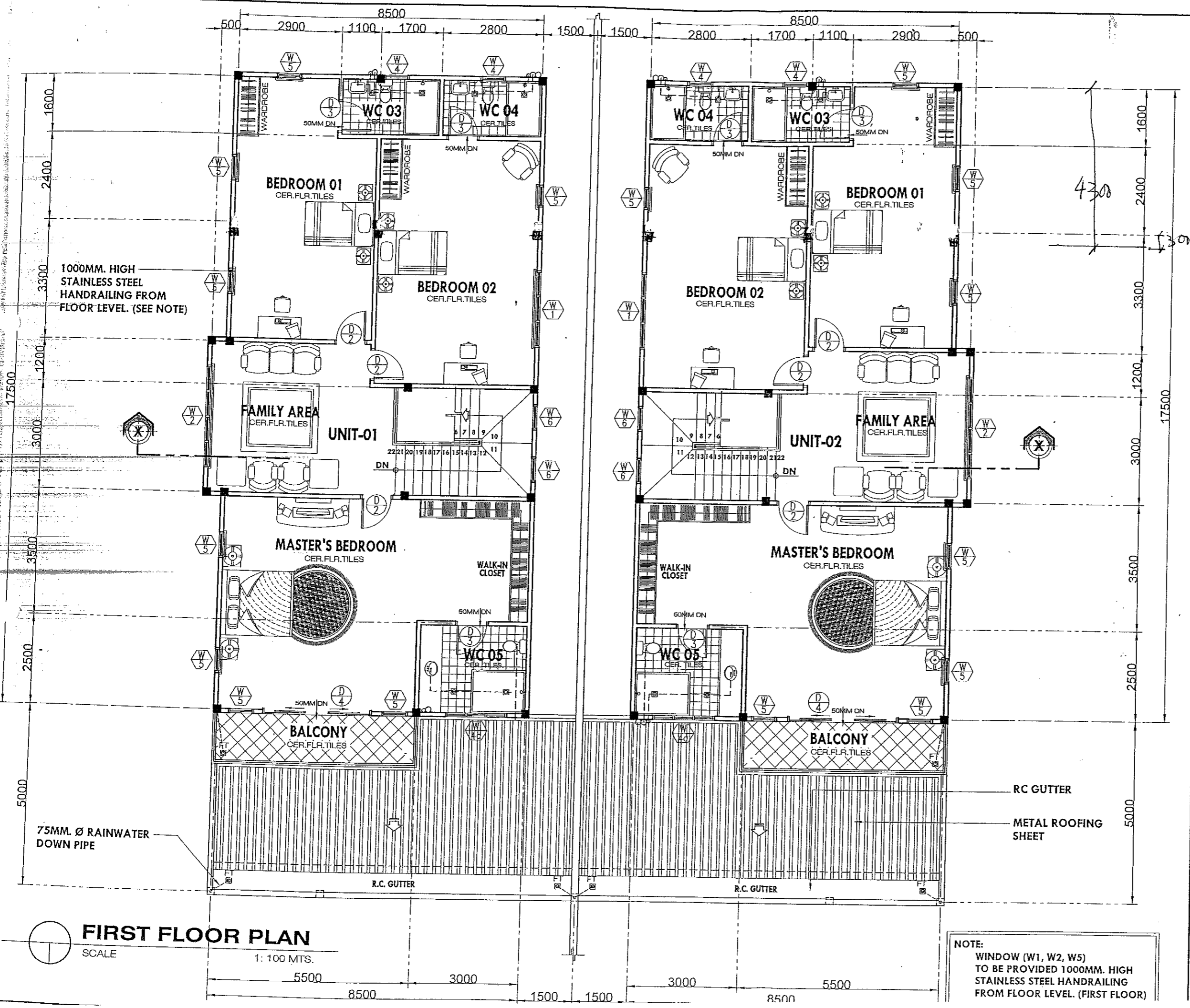

NOTES:

OWNER'S SIGNATURE

*[Signature]*

**LIM JING YIH**

IC NO. 00-284771(K)  
NO.4, SIMPANG 185, KAMPUNG SUBOK,  
BD 2717, BRUNEI DARUSSALAM

COMPANY NAME

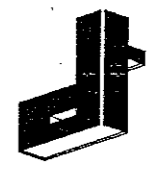

**DESIGN TEAM**  
CHARTERED ARCHITECT

P.O. BOX 96, SERI COMPLEX BA1779  
TEL. NO. 673-2-652564 / 673-2-652565

PROJECT NAME AND LOCATION:

PROPOSED 2-STORY  
SEMI-DETACHED HOUSE ON LOT 58399  
AT KAMPUNG SUBOK, MUKIM KOTA BATU  
NEGARA BRUNEI DARUSSALAM

SHEET CONTENTS:

FIRST FLOOR PLAN

SCALE	DESIGN BY:	
	DRAWN BY:	
	DATE:	
	ARCHITECT	DESIGN TEAM
	SHEET NO.	

NOTE:  
WINDOW (W1, W2, W5)  
TO BE PROVIDED 1000MM. HIGH  
STAINLESS STEEL HANDRAILING  
FROM FLOOR LEVEL. (FIRST FLOOR)